

BD Saf-T-IntimaTM

Closed IV Catheter System

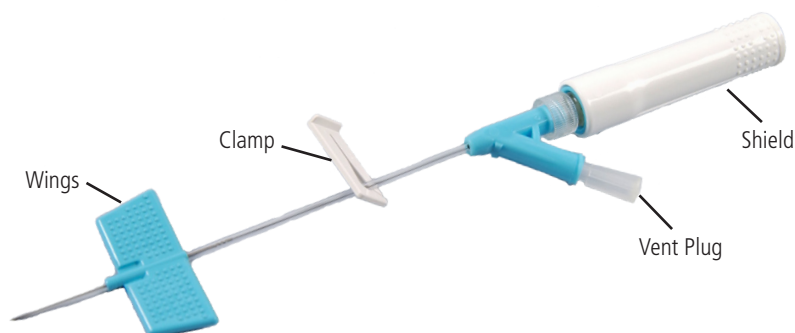

POINTS TO PRACTICE

1 PREPARATION

- > Prepare the insertion site in accordance with your facility protocol
- > Remove the needle cover and inspect the catheter
- > Secure the vent plug or remove it to pre-prime/pre-connect system
- > Holding as illustrated, rotate the shield to loosen the needle
- > Make sure the bevel is oriented upward and not covered by the catheter

2 VENIPUNCTURE

- > Grasp the pebbled side of wings and pinch together firmly
- > Access the vessel and observe flashback in the tubing behind the wings

3 ADVANCEMENT

- > Upon flashback visualization, lower the catheter almost parallel to the skin
- > Before threading, advance **entire unit** slightly to ensure the catheter tip is in the vessel
- > Release the wings and stabilize the catheter
- > Grasp the pebbles on the white shield and pull back slightly to recess needle (*Fig. 3*)
- > Advance the catheter into vein while maintaining skin traction

4 NEEDLE REMOVAL

- > Stabilize the catheter wings as shown
- > Grasp the pebbles on the white shield and pull in a straight continuous motion
- > The shield will come off, exposing the adapter
- > Place the shielded needle in a puncture-resistant, leak-proof sharps container

5 SECUREMENT

- > Secure the catheter and apply a sterile dressing in accordance with your facility protocol

CAUTION REMINDERS

- > Do not bend the needle prior to insertion
- > Never reinsert needle into the catheter as this could shear the catheter
- > Do not use scissors at or near the insertion site
- > Place all needles in a puncture-resistant, leak-proof sharps container

Consult product insert for complete instructions, warnings and cautions.

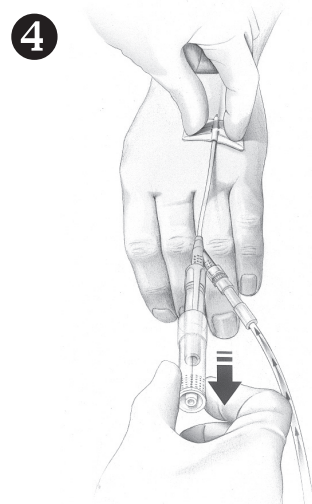
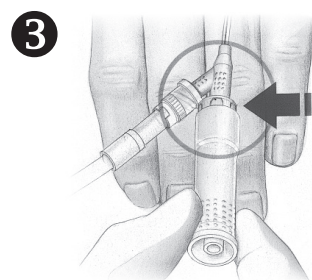
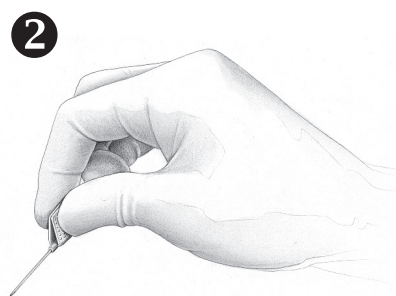
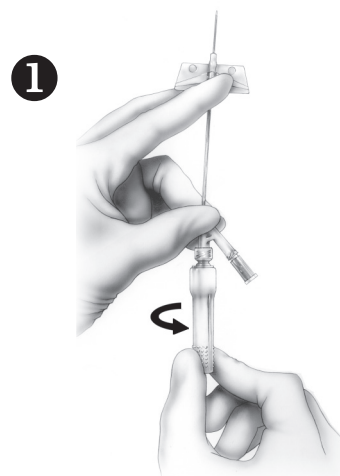

BD Saf-T-Intima™

Closed IV Catheter System

TIPS FOR SUCCESS

MAINTAINING THE BEVEL POSITION

- > Make sure the pebbled side of the catheter wings is in contact with your fingers
- > Pinch the wings tightly near the base to 'lock' the bevel position

MAKING A SMOOTH INSERTION

- > Make sure the catheter is not over the needle bevel
- > Maintain traction on the skin

INSERTION SUCCESS

- > Slow down the speed of insertion
- > Lower the initial insertion angle, keeping the elbow low
- > After flash, lower the angle and advance the entire unit slightly
- > Make sure tip seal is released by rotating the shield

ADVANCING WITH EASE

- > Make sure to release the tip seal before insertion by rotating the shield
- > After flash, lower the angle and advance the entire unit slightly
- > Do not pull back on the white shield initially more than 1/8 inch
- > Maintain traction on the skin

FEELING THE 'POP'?

- > Pop causes damage to the vein
- > Flash is a better indicator
- > Slowing the approach allows the flash to catch up
- > Sense the 'loss of resistance' when entering the vein

CONTINUATION OF FLASH

- > Normally flash will stop in product without the Y-site configuration

REMOVING THE NEEDLE EASILY

- > Make sure to release the tip seal before insertion by rotating the shield
- > Open the catheter wings flat against the skin
- > Place your fingers in **each** wing, not on the center portion
- > Only grasp the pebbled end of the white shield
- > Without hesitating, pull the needle out in a straight continuous motion until the shield pops off

ACTIVATING THE SAFETY SHIELD

- > Only grasp the pebbled end of the white shield
- > Without hesitating, pull the needle out in a straight continuous motion until the shield pops off

